

Smart toilet seat Instruction manual

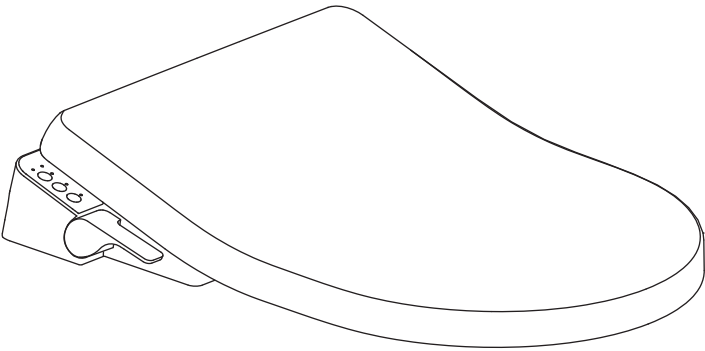

Apply to E107C



Contents

Cautions	2-5
Components name	6-8
Product installation	9-13
Confirmation before use	14-15
Operation method	16-18
Cleaning steps	18-19
Not used for a long time	20
Malfunction judgement and solution	21-22
Technical data	23

Thank you for purchasing this intelligent seat, please use is carefully after reading this manual.

Cautions

To prevent harm to users or others and property damage, Please read the [Cautions] carefully and follow them! In order to use this product correctly.



Warning

Indicates that if you ignore this flag while operating, It may cause serious injury or death.



Prohibited

The content indicated by this flag is: Unprohibited [Prohibited] content



Compulsory compliance

The content indicated by this flag is: mandatory content that must be executed

Symbol	Meaning
	The content represented by this flag is: Content that must be enforced.
	The content represented by this flag is: Unprohibited [Prohibited] content
	The content represented by this flag is: Disassembly or unauthorized modification of the product is prohibited.
	The content represented by this flag is: Prohibition of immersion in water.
	The content represented by this flag is: Do not touch with wet hands.
	The content represented by this flag is: Connected to ground.
	The content represented by this flag is: High temperature and flammable objects are prohibited.

※ Tips

Persons with disabilities and those with limited experience or common sense (including children) are required to use this product under the supervision of a person.

Do not install the product in a room where frost may form. The indoor temperature must not be lower than 0 °C. This product must be connected to the cold water supply (inlet water temperature is approximately 4~35 °C), otherwise the machine will be burn or caused trouble.

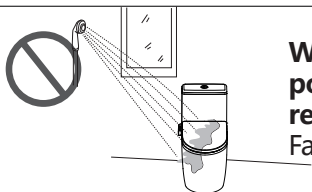

When using in a bathroom, make sure that the power outlet is waterproof. Failure to do maybe result in electric

Failure to do maybe result in electric shock or fire.

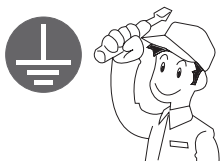

Check that the power outlet is grounded.

This product must be well grounded. Only connect a dedicated 220V, 50Hz, 10A circuit with a ground fault circuit breaker or a ground leakage protector.



If the power cord is damaged, it needs to be replaced. To avoid danger, please observe the following:

Please contact the retail store where you purchased this product or the nearby customer service center. Must be replaced by the manufacturer's service department or an authorized professional.



Please use a splash box, Do not pour water or detergent on the product and power plug.

It may cause damage to the product or fire or electric shock.

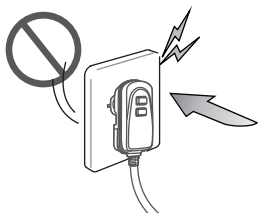

Do not use loose or faulty outlets.

It may cause fire or electric shock.



Do not plug or unplug the power plug with wet hands.

It may cause an electric shock.



Do not pull or damage the power plug/power cord at will.

It may cause fire, short circuit, or electric shock.



Please turn off the power and pull out the plug before removing or cleaning the product.
Otherwise, there is a danger of electric shock.



Do not disassemble and modify this product for any purpose, for any purpose.

It may cause fire, short circuit, or electric shock.



Do not place high temperature and flammable materials near the product. it may cause fire
Glowing cigarettes and other burning materials must not be thrown into the toilet.



Do not pour urine on the body and nozzle.

Failure to do so may result in malfunction or smudges such as pink and brown.



Do not connect any wastewater, mixed water, industrial water, sea water or other untreated or semi-treated water.

May cause skin infection or malfunction.



Do not lean on the cover.

It may damage the seat cover and cause personal injury.



Do not expose the product directly to water, strong light or sunlight.

May cause fading and unstable race temperature.



Do not install the product in a room where frost may form. The indoor temperature must not be lower than 4 °C.

Prevent product freezeage and damage the movement components.

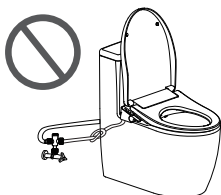

Do not bend or twist the water supply hose.

May cause water leakage.



Do not use the following items to clean the product:

Gasoline, banana water, benzene, paint thinner, decontamination powder and nylon brush.



When not in use for a long time, drain the water from the water hose and unplug the power cord.

Components Name

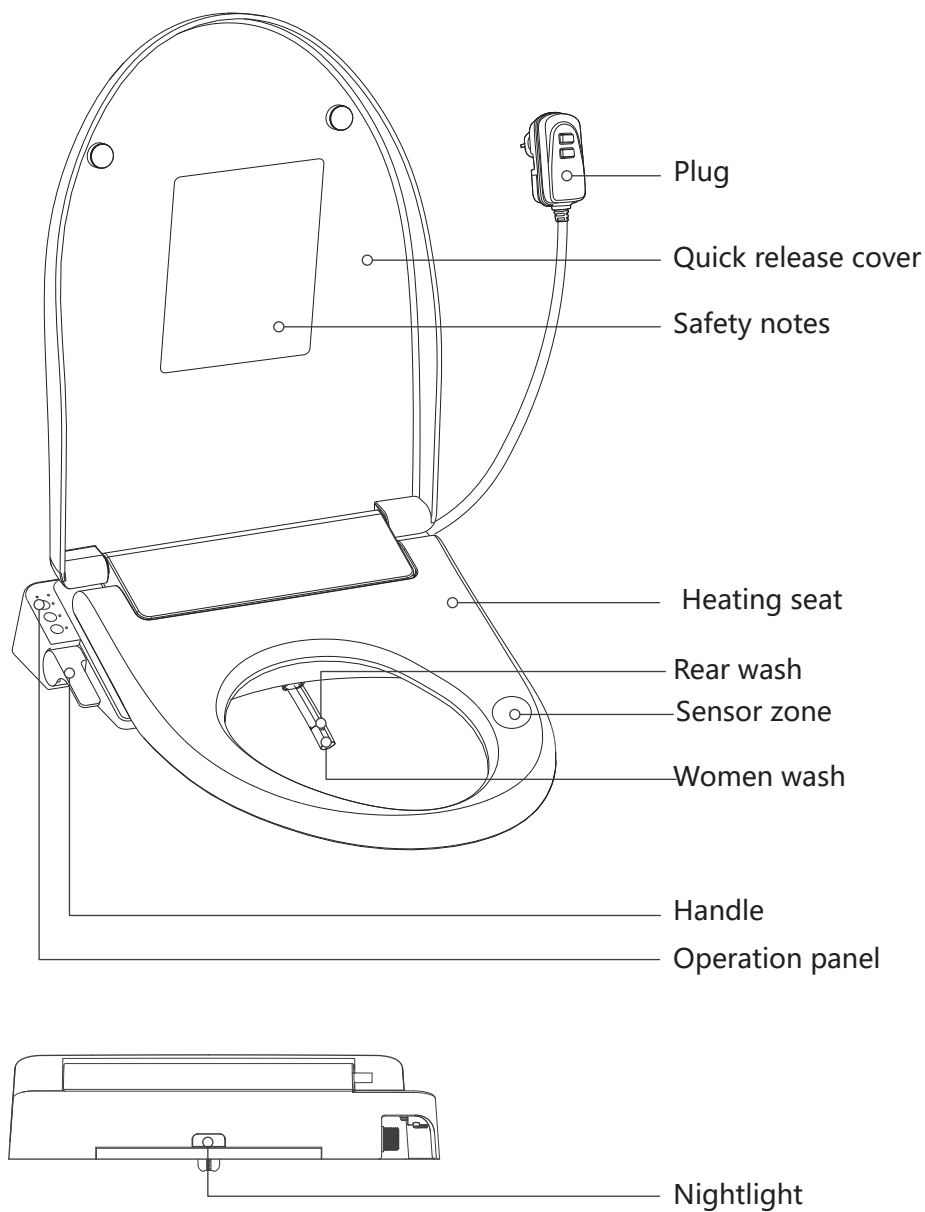

■ Components Name

Bottom inlet model

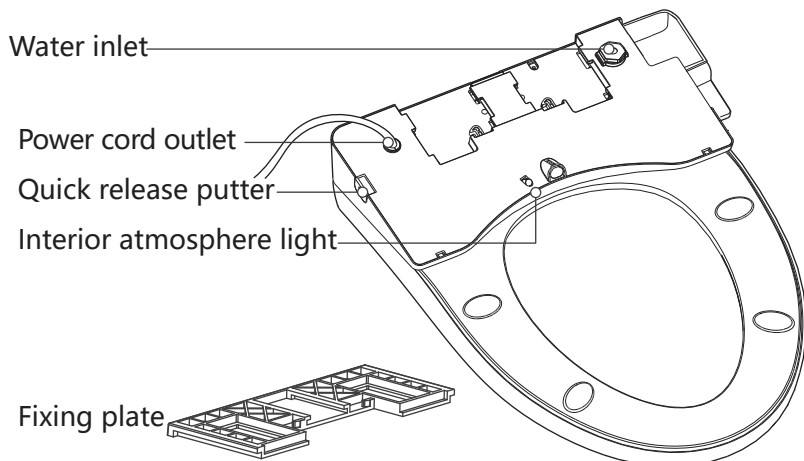

Side inlet model

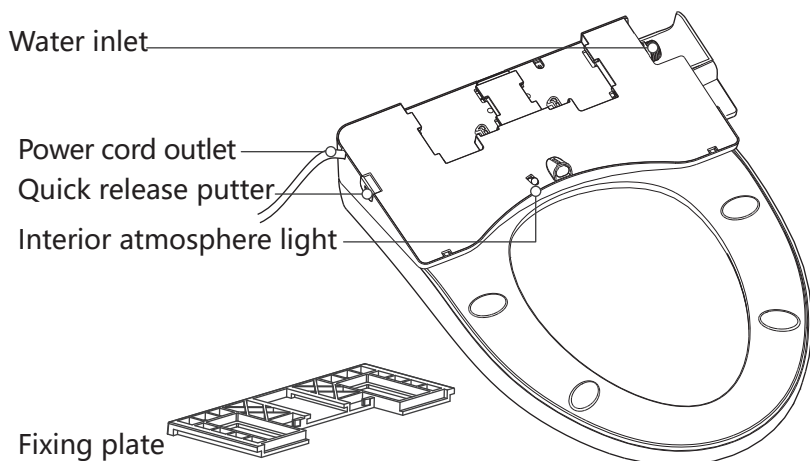

■ Accessories

Bottom inlet model

1、Main body

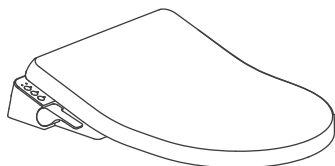

2、The printing

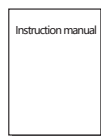

Manual (1)

3、Installation accessories

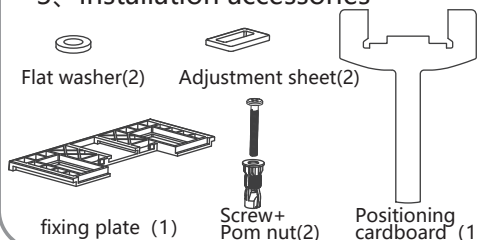

4、Waterway accessories

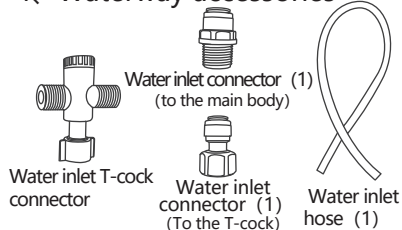

Side inlet model

1、Main body

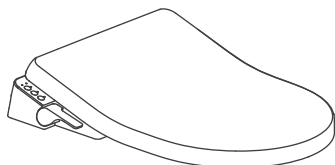

2、The printing

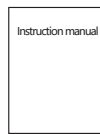

Manual (1)

3、Installation accessories

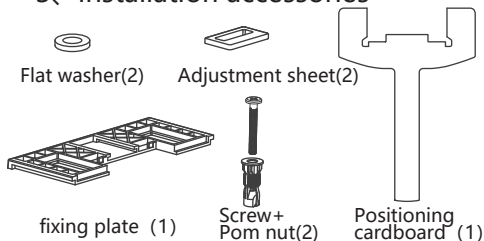

4、Waterway accessories

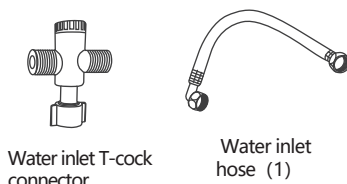

Product installation

Adapt to ceramic dimension requirements

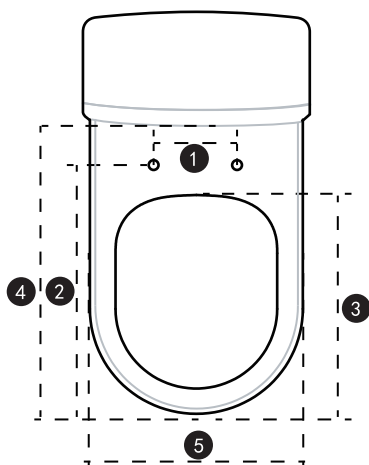

- ① Distance between mounting holes: 135-165mm
- ② The distance between the mounting hole and the front of the ceramic 430-470mm
- ③ The distance from the inner circle of the toilet to the front of the ceramic > 375mm
- ④ Distance from water tank to the front of ceramic > 505mm
- ⑤ Ceramic width ≤ 380 mm

Preparation before installation

Before installing the toilet seat

1. Remove the existing toilet and close the water supply system of the toilet.
2. Press the flush button to release the pressure from the water supply pipe.
3. Place a container with water under the water inlet valve.
4. Disconnect the toilet inlet valve from the water supply pipe.

Note: When determining the location of the circuit exit, follow local standards

1. The inlet of the separate seat is on the left side and the bottom.
2. When the water inlet is from the bottom, the ceramic holes must be able to pass through the power cord and water inlet pipe.

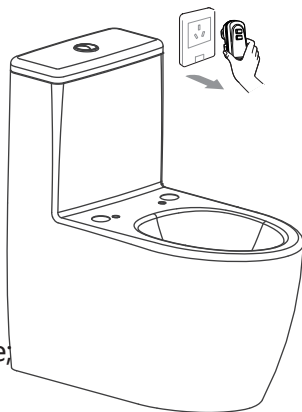

Installation circuit outlet

1. Before installing the circuit, please reserve a power socket within about 1 meter to the right of the toilet.
2. It is recommended to use waterproof sockets. Do not use extension cords to connect the product.

■ Installing the fixing plate

1. Open the angle valve to drain water for 10S, and confirm that the inlet water channel is normally flowing.

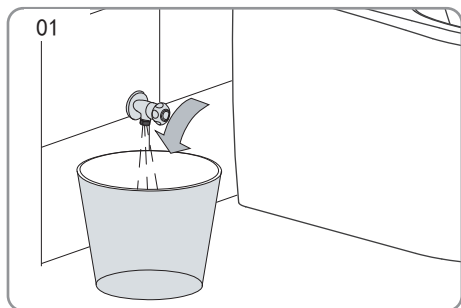

2. Place positioning cardboard, align the front of the cardboard with the front of the ceramic.

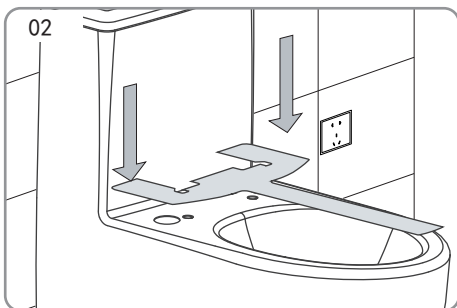

3. Plug the expansion screw into the ceramic mounting hole, place the fixing plate in the hollow position of the positioning cardboard, place the adjustment piece according to the position of the ceramic installation hole, and screw the adjustment piece to lock the fixing plate to the ceramic.

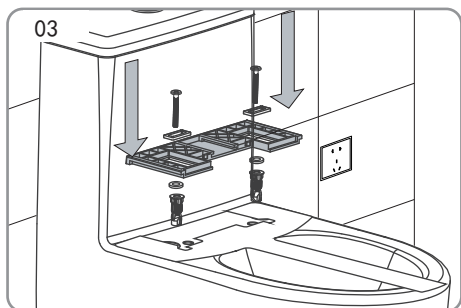

4. After the installation of the fixing plate is completed, remove the installation positioning cardboard.

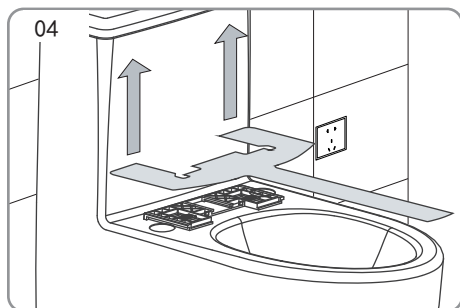

■ Toilet pipe

Bottom inlet

1. Unscrew the plug at the bottom water inlet.

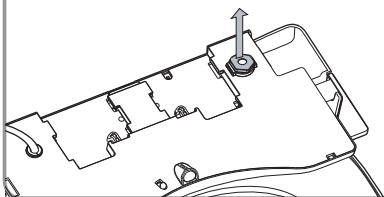

2. Connect the water inlet connector and the water inlet in the accessory kit, and then insert the water inlet pipe into the water inlet connector.

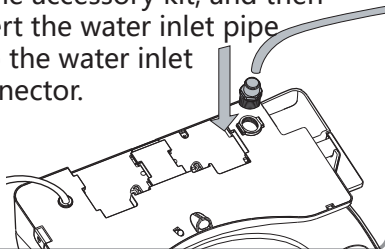

Side water inlet

Connects the hose in the accessory package with the water inlet joint.

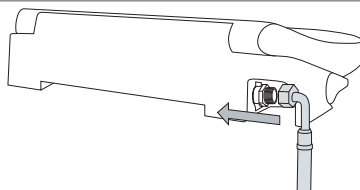

■ Toilet installation and removal

Side inlet

Installation:
Align the toilet with the fixing plate, push it in the direction of the arrow, and hear a "click" sound, indicating that the toilet is installed in place.

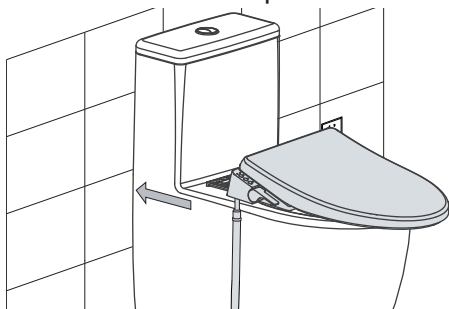

Disassembly:
Press the side quick-release pusher inward and pull out the toilet horizontally with both hands.

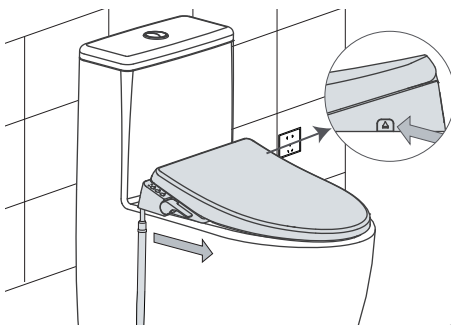

Bottom inlet

Installation:

Pass the power cord and water inlet pipe through the ceramic rear hole, and align the toilet with the fixed plate (the exposed length of the fixed plate is about 15mm, the rear shell is flat against the ceramic), and then push in the direction of the arrow on the right, and hear a “click” indicating that the toilet is installed in place.

Disassembly:

Press the side quick-release pusher inward, pull the toilet horizontally with both hands until it is loose (the exposed length of the fixing plate is about 15mm), and then lift the toilet upward.

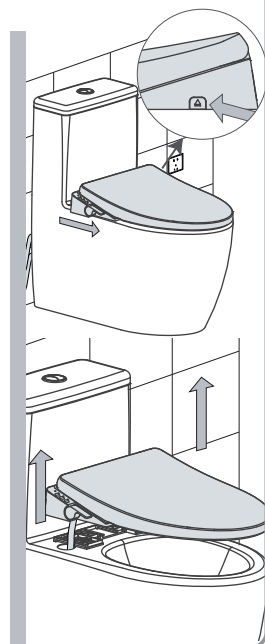
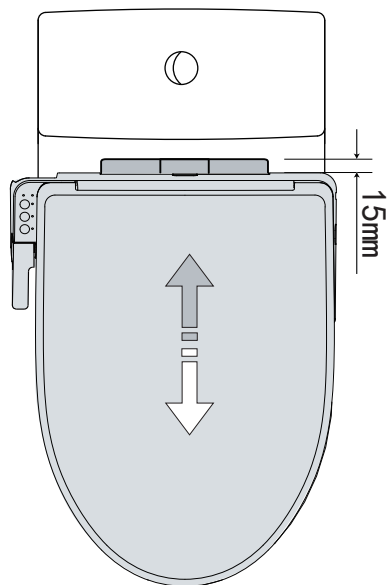
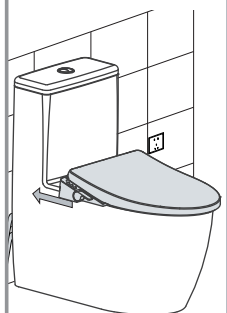
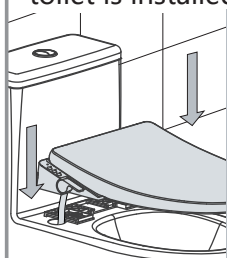

■ Connect power and water

■ Bottom inlet water supply

Connect the external water source to the water inlet connector with the supplied hose and filter

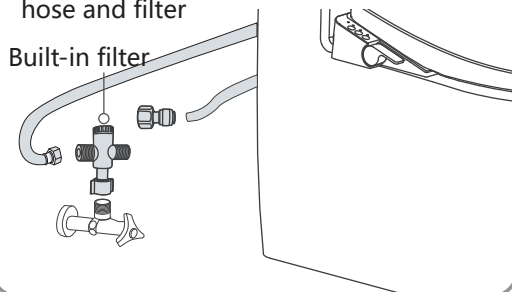

Separate water and electricity installation locations

Notice

In the same room where this product is installed, you need to install a water stop valve within easy reach. It is used in emergency situations to cut off the water inlet of the product without the use of tools. Otherwise, unexpected failure of the product may cause user loss

■ Side inlet water supply

Connect the external water source to the water inlet connector with the supplied hose and filter

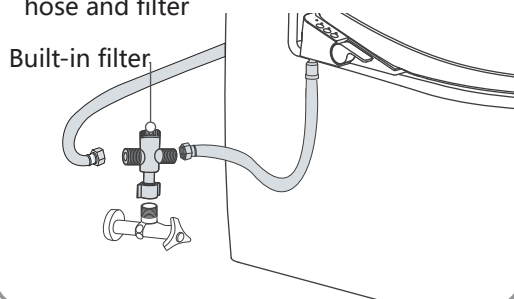

Notice

1. Applicable water pressure range: 0.075-0.8MPa
2. Applicable water temperature range: 4-35°C
3. Usage environment 0-40°C, relative humidity ≤ 95%;
4. The new hose must be used. The old hose assembly cannot be reused.



■ Connector power:

1. 220V (greater than 10A) socket installed at a position 50cm above the ground.
2. The socket must be installed in a place where water cannot easily splash.
3. Use a grounded socket.
4. Plug the power plug of the product into the socket.

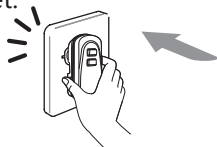

Notice

The plug should be connected to a valid grounded socket, otherwise it may cause electric shock in the event of power failure or leakage.



Warning

Please connect the power according to the product power supply requirements, Otherwise it may cause the product to malfunction.



Confirmation before use

■ Open the valve

Open the water inlet valve to provide water for the whole machine

■ Confirmation and pilot run

1. Detect power

Make sure the power plug is plugged in tightly. The indicator light on the plug indicates that the system is powered on. If the indicator light is not on, you can press the reset button on the plug to power on. After the power is turned on, the system emit a beep.

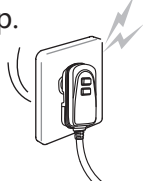

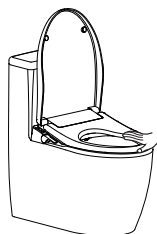

2. Seat sensor

There is a seat sensor in the area shown in the figure. Only when the system senses that someone is seated, the system emits a beep.



3. Check panel function

Press the "night light",  "seat temperature",  and "water temperature",  on the panel to see if the related function indicators are normally on / off.

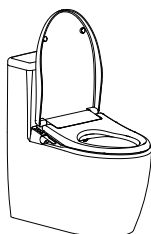

4. Check flush function

When the human body seat induction is on, press down / up the handle to see if the nozzle is extended normally to start the women wash / rear wash function.

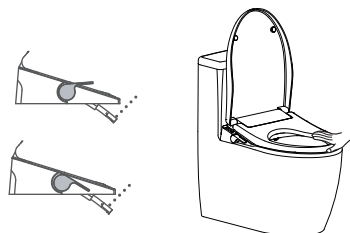

■ Operation panel

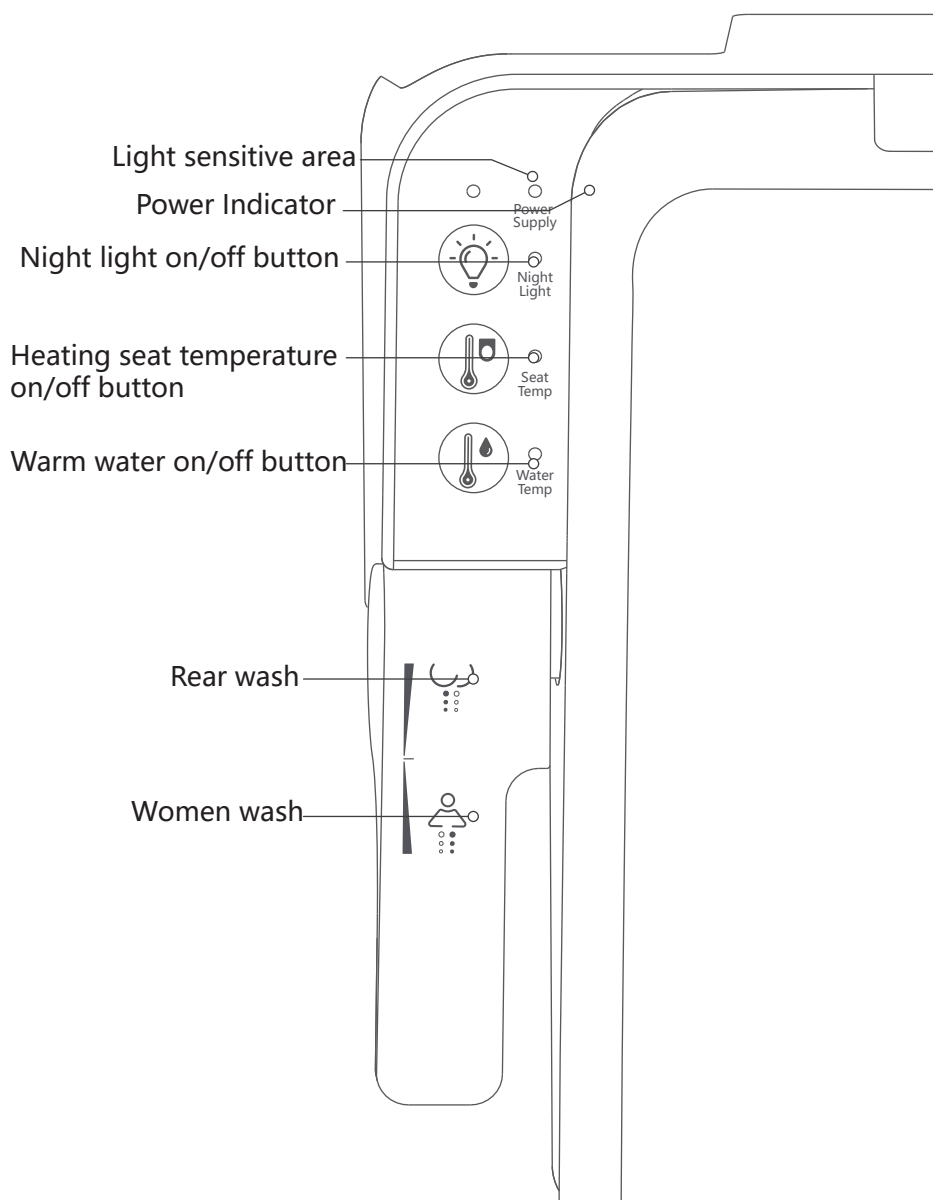

Operation method

■ Operation panel function illustrate

■ Stop

- Lift the handle parallel to the operation panel, you can end the "rear wash" and "women wash"

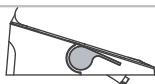

■ Rear wash

- When someone is seated and sensed by the seat, lift the handle up and the nozzle extends to start the rear washing function; The water flow changes with the rotation of the handle; After the rear wash, lift the handle down until it is parallel to the operation plane. (There will be a sense of shifting, accompanied by a "click" sound)

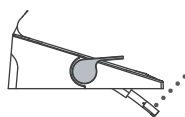

The rear wash is a stream of air bubble water with massage function for a gentle and comfortable experience.

When the seat does not sense someone sitting, lift the handle up to open the rear wash, the nozzle will not extend out, but only water come out from the self-cleaning mouth, and with "beep" alarm.

■ Women wash

- When someone is seated and sensed by the seat, lift the handle down and the nozzle extends to start the women washing function; The water flow changes with the rotation of the handle; After the women wash, lift the handle up until it is parallel to the operation plane. (There will be a sense of shifting, accompanied by a "click" sound)

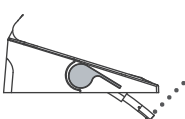

The women wash is a stream of air bubble water with massage function for a gentle and comfortable experience.

When the seat does not sense someone sitting, lift the handle down to open the women wash, the nozzle will not extend out, but only water come out from the self-cleaning mouth, and with "beep" alarm.

■ Power Indicator

- The power indicator is always on after the power is turned on.

■ Nightlight

- Press the night light button  , the night light function is turned on when the indicator light is on; the night light function is turned off when the indicator light is off.
(Remarks: The night light is controlled by the light sensor, and the light intensity of the external light source is <2 Lux. The night light will be on. If the light intensity of the external light source is > 2 Lux, the night light will automatically turn off.)

■ Seat temperature

- Press the seat temperature button  , when the indicator light is on, the seat heating function is turned on; when the seat is not sensed, the seat is warmed at 34 ° C. After the seat is sensed, it is heated to a comfortable 37.5 °C; After the temperature reaches to 37.5 °C, the seat will automatically cool down to 33 °C to prevent low temperature burns; When the indicator light is off, the seat heating function is turned off.

■ Water temperature

- Press the water temperature button  , when the indicator light is on, the water temperature heating function is turned on; when the indicator light is off, the water temperature heating function is turned off.
(Note: When the warm water cleaning function is needed, if the product water temperature is set to off, please turn on the water temperature button before using to ensure comfort.)

■ Function description

1、Seat detection

There is a seat detection switch on the toilet seat, used to detect whether a person is seated when the power is on. When the person is seated, the "rear wash" and "women's wash" functions can be turned on; When the seat does not sense someone sitting, turn on above functions, the nozzle will not extend out, but only water come out from the self-cleaning mouth, and with "beep" alarm. When the product is powered off, the seating detection does not work, the warm water washing functions and heating seat function cannot be used, but only normal temperature water with "rear wash" and "women wash".

2、Nozzle self-cleaning

Before the "rear wash" and "women wash" functions starting, the nozzle is self-cleaning, and then the nozzle is extended to start the "rear wash" and "women wash" functions; When the seat does not sense someone sitting, turn on rear wash and women wash functions, the nozzle will not extend out, but nozzle will start self-cleaning and machine with "beep" alarm.

3、Protected against low temperature burns

When the seat is sensed, it is heated to a comfortable 37.5 °C; After the temperature reaches to 37.5 °C, the seat will automatically cool down to 33 °C to prevent low temperature burns;

Cleaning steps

■ Product cleaning

1、Cleaning nozzle

- Use your forefinger to hold the bottom of the nozzle and gently pull out the nozzle; use a soft cloth, sponge or small brush to apply neutral detergent;
- Gently hold the nozzle and wipe the nozzle and sprayer
- Put back the nozzle, switch to rear or women wash, clean the detergent and dirt with self-cleaning water.

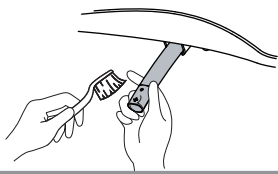

- #### 2、Cut the power supply
- Unplug the power plug before cleaning the product body.

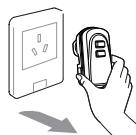

3、Cleaning the surface of the product

- Please wipe the surface of the product with normal temperature water or neutral detergent with a sponge or a soft cloth.
- When using detergent to clean other parts, please lift up the cover and seat.
- After the detergent in the ceramic toilet is completely washed, the seat can be covered again, otherwise the evaporation of the detergent may corrode the surface of seat and cover.

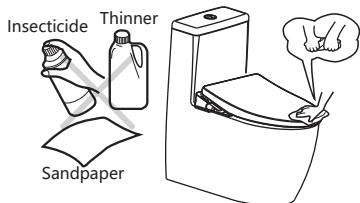

4、Quick release cover

When the cover is opened to 85-90°, pull up the left side of the cover until the cover is removed from the left shaft, and then move it horizontally to the right, so that the right side of the cover is also removed from the shaft; Then the cover can be removed for sanitary dead corner cleaning.

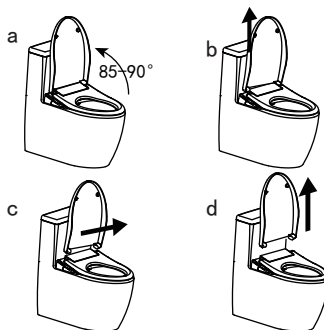

5、Clean the filter

- Disconnect the power supply, close the angle valve, and then unscrew the filter on the three-way valve. After removing the filter, rinse the impurities under the tap water;
- When the water flow is smaller than usual, please clean the filter.
- After cleaning, please replace the filter in reverse order.

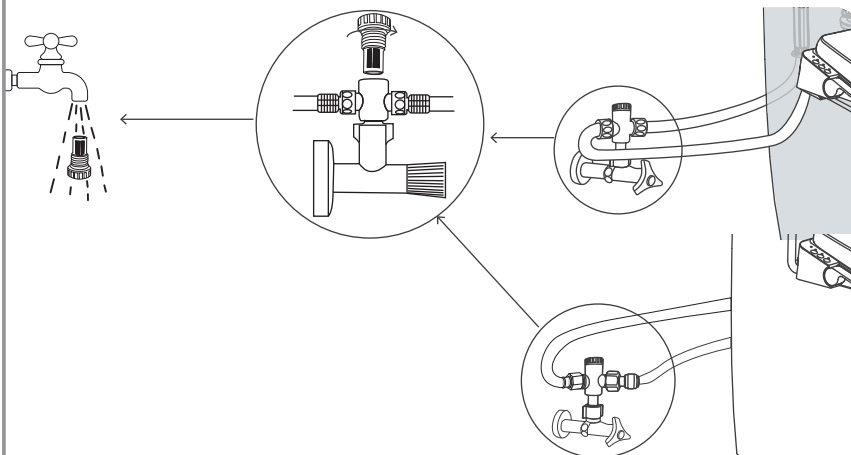

Not used for a long time

■ Drain and disconnect power supply

- 1、Unplug the power plug



- 2、Close the angle valve to stop the water supply, remove the water inlet hose from the angle valve to the toilet end, and drain the water in the water inlet hose.

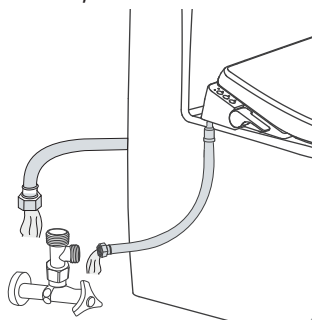

Warning

When using the product again, please confirm before using it (refer to page 12)



■ Product maintenance in winter

- 1、Keep the power on when not using the product temporarily;
- 2、Maintain proper water temperature to prevent the water in the water tank from freezing.

Malfunction judgement and solution

■ Malfunction judgement and solution

Malfunction	Reason	Solution
Leakage in flushing assembly	The handle is not screwed back to the stop position	Turn the handle back to the stop position
Seat temperature is too low	Seat heating function is not turned on	Turn on the seat heating function
Nozzle not extend out but only water out	Low inlet water pressure	Remove impurities in the filter of the water pipe, or use a higher water pressure source
	No user seating detected	Ensure that the user is in contact with the sensing position
	Water temperature exceeds 43 degrees	Turn off the warm water on the operation panel, and then turn on the warm water after a period of time
Nozzle extended too slowly	Low inlet water pressure	Remove impurities in the filter of the water pipe, or use a higher water pressure source
Low water flow	Insufficient rotation of the handle	Increase the angle of turning the handle
	Filter clogged	Clean the filter at the inlet connection
The operation panel indicator is off	No power or leakage protection switch is not closed	Re-plug the plug, and press the "Reset" key of the leakage protection, and observe whether the indicator light is on
Night light is off	The night light switch is turned off	Turn on the night light function on the operation panel

■ Malfunction alert

Malfunction	Buzzer alert
Inlet water temperature probe is shorted	The buzzer beeps 3 times every 10 seconds, each time 0.5 seconds with interval of 1 second; the system will stop the water heating when this information appears
Temperature exceeds 43 degrees	The buzzer beeps 5 times every 10 seconds, each time 0.5 seconds with interval of 1 second; the system will stop the water heating and nozzle retracted when this information appears
Outlet water temperature probe is shorted	The buzzer beeps 2 times every 10 seconds, each time 0.5 seconds with interval of 1 second; the system will stop the water heating when this information appears
Seat temperature probe is shorted	The buzzer beeps 4 times every 10 seconds, each time 0.5 seconds with interval of 1 second; the system will stop the water heating when this information appears
Outlet water flow is too small	The buzzer beeps 1 time every 10 seconds, each time 2 seconds; the system will stop the water heating and nozzle retracted when this information appears

■ Explanation of other buzzer sounds

Buzzer alert	Explanation
The buzzer sounds 0.5 seconds, and the interval is 0.5 seconds	The system is in the cleaning state, but no human seat is detected;
1 buzzer, 1 second	Detection of human seating;
The buzzer sounds 0.5 seconds, and the interval is 0.5 seconds	It is detected that the user is out of seat and the handle is not closed. When this information appears, the system will stop the water temperature heating, the nozzle retracts, and the self-cleaning mouth will continue to emit water, prompting the user to close the handle and stop the water.



After performing the above-mentioned corresponding treatment, it still cannot be used normally, or an abnormal phenomenon other than this table appears, please contact the company customer service center or the seller

Warning

- Do not disassemble, repair or modify the product yourself
- It may cause electric shock, fire or malfunction



Compulsory compliance

Technical data

Model		E107C
Water inlet		G 1/2
Applicable voltage		AC220V, 50Hz
Power		900W
Applicable water pressure		0.075 ~ 0.8MPa(0.75 ~ 8Bar)
Applicable water temperature		4 ~ 35°C
Waterproof rating		IPX4
Flushing device	Flushing flow	480-560mL/min
	Flushing water temperature	37.5 ± 1.5°C
	Flushing cycle	Manual control
	Warm water heating method	Instant
	Maximum heating power	1400W
	Safety device	Thermal fuse, thermostat
Heating seat	Surface temperature	37.5 ± 1.5°C
	Heating power	50W
	Safety device	Thermostat, temperature fuse
Product dimension		500*402*94 mm

Service card			
Product model			
Serial number		Purchase date	
Dealer		Telephone	
City	Province	Country	Dealer's stamp
Maintenance regulations: 1. In accordance with the instructions and precautions for use, if a failure occurs after normal use, repair will be performed free of charge during the warranty period. 2. Please contact the company's customer service center or the seller for repairs due to failures during the warranty period, and show the repair service card during repairs. 3. Although it is under warranty, the following conditions will be charged for maintenance. -Failures due to carelessness or negligence during use, and failures due to improper repair or modification. -Failure or damage to the mobile installation location. -Faults and damage caused by fire, earthquake, flood, lightning, and other natural disasters, pollution, or abnormal voltage. -Failures and damage caused by the use of unspecified power sources (voltage, frequency). -Used for purposes other than general domestic use, malfunctions or damage. -Cases where this repair card cannot be provided. -When the unit sold, the installation date, the seal of the dealer, etc. are not filled in this repair card or the contents are modified without authorization. 4. This repair card is no longer issued, please keep it properly. About service Customer rights Customers have the right to repair free of charge if a failure occurs within one year from the date of purchase. However, if the customer's fault or natural disaster occurs, maintenance will be charged even during the warranty period.			

Service card	
Product number	
Serial number	
Customer name	
Contact number	
Detailed address	
Units sold	
Contact number	
Purchase date	

Thank you for choosing us



VIVO Sp. z o. o.

Add: Bartycka 26/24, 00-716 Warszawa, Polska

Tel. +48 888 593 158

Kom. +48 735 877 668

Email: vivo@majormaker.pl

www.majormaker.pl