

Intelligent Toilet instruction manual

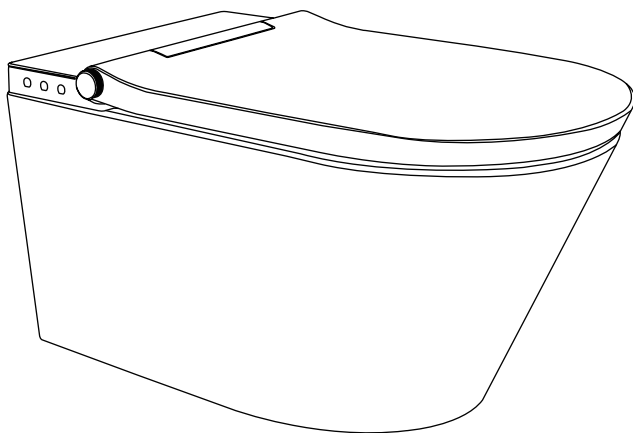

Apply to MM-4020-F



■ Thank you for purchasing this intelligent seat,
please use is carefully after reading this manual.

Thank you for purchasing this Intelligent seat.

Please read the instructions and related illustrations care-fully before installing and using the seat.

There may be differences between objects and illustrations.

A warranty card is included in this manual, please keep it in a safe place for future reference.

If you have any problem for the installation or performance, please be sure to contact us.

Features available for your product

Urea formaldehyde material	√
Rear Wash	√
Front wash	√
Mobile massage	√
Mixture massage	√
Adjustable water pressure	√
Adjustable water temperature	√
Adjustable nozzle position	√
Self-cleaning nozzle	√
Soft close for the cover	√
Flat slow down	√
Ambient light, night light	√
The hot water	√
Safety leakage protection	√
Drying	√
Seat heating	√
Pre wetting	√
deodorization	√
Descaling	√
Ceramic mounting accessories	√
Horizontal remote control	√
Vertical remote control	√
Side of the knob	√
EN1717	√
IPX4	√
CE	√
RoHs	√

Contents

Chapter 1 Safety caution	02
1.1 Normal using	03
1.2 User requirements	03
1.3 Use only when the device is in a normal state	03
1.4 Toilet seat body using	03
1.5 Battery using	04
1.6 Other safety precautions	05
Chapter 2 Overall machine overview	11
2.1 Toilet seat body	11
2.2 Remote control front button illustration	12
Chapter 3 Operating Instruction	13
3.1 Initialization Instructions	13
3.2 Toilet Button Description	16
3.3 Rotate Knob operation instructions	17
3.4 Remote button operation instructions	18
Chapter 4 Cleaning and Maintenance	25
4.1 Toilet seat body cleaning	25
4.2 Nozzle and sprayer clean	25
4.3 Remote control cleaning	26
4.4 Deodorizing device cleaning	27
4.5 Descaling	29
4.6 Waste disposal	30
4.7 Product maintenance	30
4.8 Winter product maintenance	31
Chapter 5 Fault predication and Troubleshooting	32
Chapter 6 Technical date	36

Chapter 1 Safety caution

In order to prevent harm to users or others and property damage, please read [safety caution] carefully and be sure to comply with it!



Warning

If this sign is ignored, it may cause serious injury or death.



Notice

If this sign is ignored, it may cause personal injury or property damage.

The logo and its meaning are as follows:



The content represented by this flag is:
Content that must be enforced.



The content represented by this flag is:
Cannot perform [forbidden] content.



The content represented by this flag is:
Disassembly or unauthorized modification of the product is prohibited.



The content represented by this flag is:
Connected to ground.



The content represented by this flag is:
Prohibition of immersion in water.



The content represented by this flag is:
Do not touch with wet hands.



The content represented by this flag is:
High temperature and flammable objects are prohibited.

To ensure that you can enjoy the intelligent toilet seat, please read the instructions carefully, especially the safety instructions . Please keep this instruction manual properly. If the product needs to be transferred to others, please be sure to attach this instruction manual. All instructions have been confirmed in accordance with the latest technical status of the equipment at the time of printing delivery. The company reserves the right to make changes as a result of further development.

1.1 Normal Using

This machine is an intelligent toilet seat with rear wash and Front wash function, can be used as a regular toilet seat . It can only be used for enclosed Spaces. Any other using will be deemed to be inconsistent with normal use .For abnormal using, The company does not assume any responsibility. does not assume any responsibility.

1.2 User requirements

For children and people who do not understand the equipment, and people with physical, sensory, mental and other defects, can use the product after safety guidance or under the supervision of other personnel .

Make sure children do not play with this product.

1.3 Use only when the device is in a normal state



Make sure the power cord is not damaged.

The power cord cannot be jammed or squeezed.

Keep the power cord away from hot surfaces and sharp edges.

Do not use the toilet seat when it is not working properly. Disconnect the power supply, close the stop valve, stop the water supply, contact the customer service hotline to avoid product failure and damage caused by improper use.

1.4 Toilet seat body using

The cold water of the toilet seat shall be connected from the main water supply pipe.

Use the new hose assembly that comes with the appliance. The old hose assembly cannot be reused.

The product itself does not have the function of leakage protection, should be installed in the line of leakage protector can be used.

The fixed wiring must be provided with a device for full-stage disconnection under the condition of overvoltage class III according to the wiring rules and the contact distance.

The specification of the fixed wiring power line is the nominal cross-sectional area of the conductor 1-2mm² (17-14AWG)

Confirm that the grounding end of the power supply wire is 10mm (3/8 ") longer than the live wire (L) and zero wire (N).

please make sure that the electrical junction box has been fixed on the wall before install the product.

Condensation moisture may occur if the temperature of Intelligent seat is moved from a colder to a hotter location. Please turn off the device for a few hours.

Do not contaminate, spray or clog the cleaning sprayer on purpose.

Please do not flush newspaper, diapers, sanitary napkins and other articles into the toilet seat , they are easy to block the product. Maintenance work must be carried out by the relevant professional staff.

Please do not use the unrecommendation accessories .

1.5 Battery using



Do not touch skin, eyes or mucous membranes if battery acid leaks.

If you touch the acid, flush the affected area with plenty of water and see a doctor immediately.

Keep the battery out of reach of children .If swallowed, batteries can be life-threatening .If the battery has been swallowed, seek medical advice immediately.

Do not charge the battery, do not use other tools to reactivate the battery, do not remove the battery, put it in the fire or make it short circuit.

When the battery runs out, remove it from the control immediately. Otherwise the liquid may leak and cause damage.

Do not put the old and new batteries into the remote control.

Clean the battery and contacts before loading the battery. Pay attention to the correct polarity of the battery when installing.

If the control is not used for a long time, please remove the battery.

Do not put the battery in extreme conditions: do not contact with heat or exposure to the sun. Otherwise, leakage may occur.

1.6 Other safety precautions



People with disabilities and lack of experience or common sense (including children) should use the product under the supervision of a designated person.

This product must connect the cold water supply (water temperature about 1 ~ 30 ° C), otherwise it may burn or machine fault.

In case of abnormality or failure, please immediately disconnect the power supply, close the inlet Angle valve and stop using.

The abnormal and fault conditions are as follows :

- The product is cracked or damaged
- Products smoking
- Abnormal sound and burnt smell
- Product heating anomaly
- Water seepage from inside pipes and products

Continued use regardless of product failure may result in electric shock, fire, injury, or indoor seepage.



Do not put your fingers or other objects into or block the drying outlet. Otherwise, it may cause scald, electric shock or parts damage.

This product belongs to electrical products, so please do not install it in places where it is easy to be soaked by water or high humidity.

Do not spill water or detergent on the product, the bottom of the product and the power plug, or it will cause electric shock, short circuit and fire.



Do not hold the lid or ring to pick up the product.

Do not open the lid or ring when there is something on the lid or ring. Otherwise may cause the product damage and causes the personal injury.



When using in the bathroom, make sure the power outlet is waterproof. If not waterproof measures, may cause electric shock or fire.



Warning



Prohibition of immersion in water

Do not spray water or detergent on the body and power plug.

May cause product damage or fire, electric shock.



Connected the ground wire

Check the power socket is grounded or not. This product must be ground good. Can only be connected to the dedicated 220v, 50Hz, 10A with ground fault circuit breaker or ground leakage protector circuit.



Mandatory compliance

After removing the dust from the plug, be sure to firmly insert the power plug into the socket. Unplug and clean with a dry cloth.

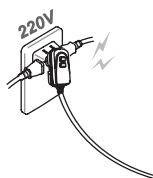

Do not use too much load on the same socket

Suitable for professional distribution with ac voltage 220V~240V (50/60Hz) only.

Otherwise, it may lead to overheating or fire.



Warning



Pull out the plug

When not in use for a long time, drain the water from the water hose and unplug the power cord. Doing so may cause water pollution and skin infections.



Prohibit high temperature

Do not place high temperature and flammable materials near the product. It may cause fire.



No dismantling

For any purpose, do not separate, repair or alter this product on your own. It may cause fire, short circuit and electric shock.



Must be obeyed

Unplug when thundering. May cause electric shock.

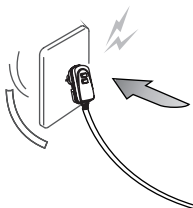

Prohibited

Do not use loose or faulty outlets. It may cause electric shock or fire.



Warning



Ban on wet hands

Do not plug or unplug the power plug with wet hands.

It may cause an electric shock.

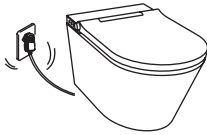

Prohibited

Do not pull or damage the power plug / power cord.

It may cause fire, short circuit, or electric shock.

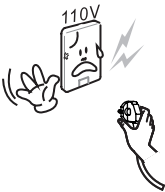

Prohibited

Do not use a DC or AC power supply that is not 220V.

May cause product failure.



Pull out the plug

Please cut off the power and pull out the plug before removing or cleaning the product. It may cause electric shock or fire.。

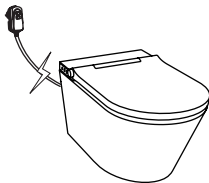

Must be obeyed

If the power cord is damaged, it needs to be replaced. To avoid danger, please observe the following: Please contact the retail store where you purchased this product or the nearby customer service center. Must be replaced by the manufacturer, its service department or an authorized professional.



Notice

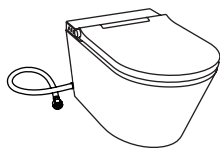

Prohibited

Do not bend or twist the water supply hose.
It may cause water leakage.



Prohibited

Do not lean on the cover.
It may damage the seat cover and cause personal injury.



Prohibited

Do not allow children to play on the seat or on the cover, do not step on, sit or place heavy objects on the cover.
May cause personal injury or damage to the product.



Prohibited

Do not install Intelligent seat in a room where frost may develop. Indoor temperature shall not be less than 4 °C.
In order to prevent product freezing, damage to the movement of the device.

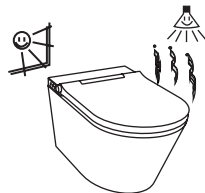

Prohibited

Do not expose the Intelligent seat directly to water, strong light or sunlight.
May cause fading and unstable race temperature.



Notice



Prohibited

Please do not force the cover and seat to close.
May damage the product.



Prohibited

Do not pour urine on the body and nozzle.
Otherwise, it will lead to malfunction or stains
such as pink and brown.



Prohibited

Do not use the following items to clean the pro-
duct: Gasoline, banana water, benzene, paint
thinner, decontamination powder and nylon
brush.

May damage the inlet pipe or product.



Prohibited

Keep away from the product when using the
radio.

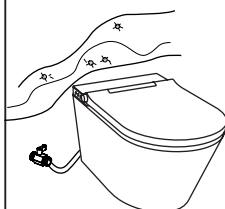

Prohibited

Do not connect any wastewater, mixed water,
industrial water, seawater or other untreated or
semi-treated water.

It may cause skin infection or malfunction.

Chapter 2 Overall machine overview

2.1 Toilet seat body

Heating seat model

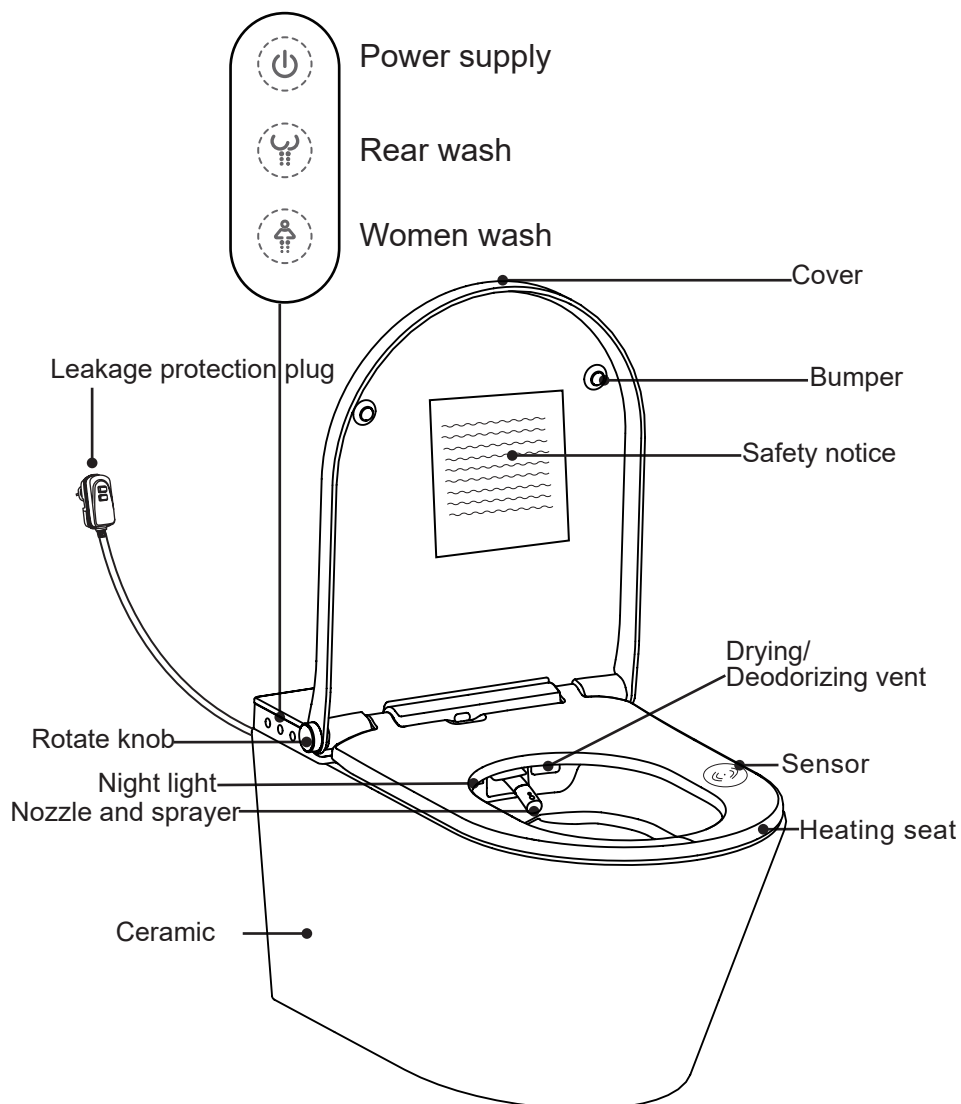

2.2 Remote control button overview

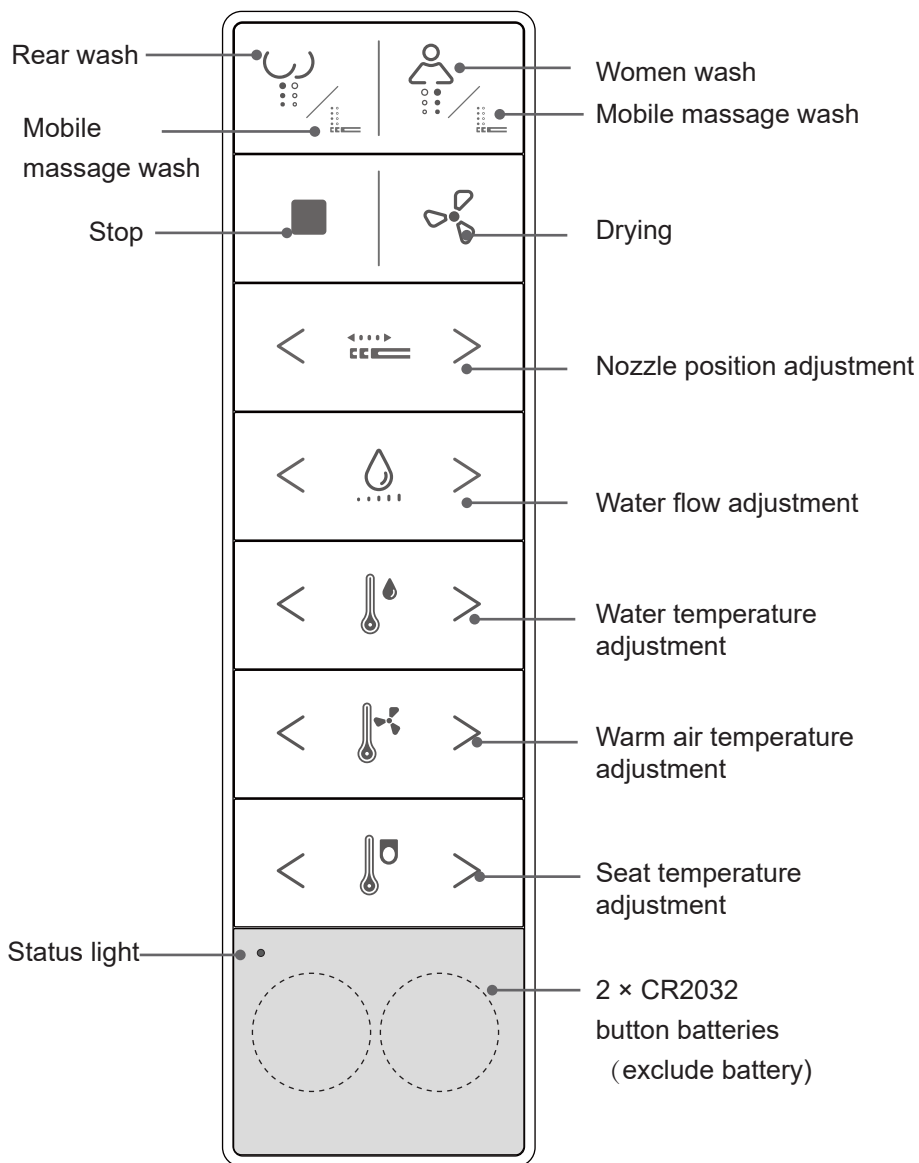

(See pages 18-24 for details of each button function)

Chapter 3 Operating Instruction

3.1 Initialization operation

1.Open the intake valve and make sure the tap water is connected.

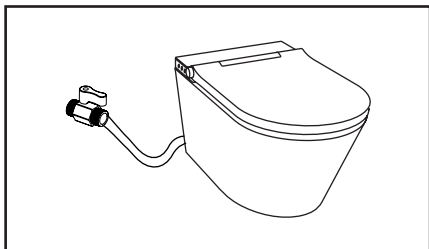

2.Battery the remote control

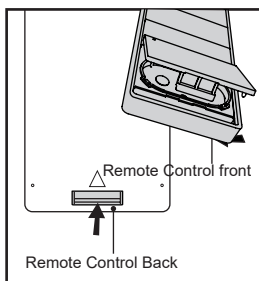

a. At the arrow position on the back of the remote control, pull it up forcefully

and open the front battery cover as shown

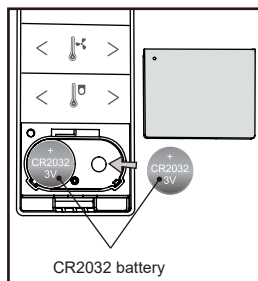

b. Install two CR 20 3 2 button batteries, note that the battery is printed with + CR 2032 3V

for the positive side of the battery

Try to operate the remote control. If the state light of the remote control lights up with the button, the battery will be installed successfully. If the remote control is not available, please check whether the battery is charged and correctly installed. If the battery is dead, you can reinstall the new battery in the above way.

In order to prevent the battery from rupturing or leaking, be sure to observe the "Precautions for Use". (Page 4)

3.Code checking

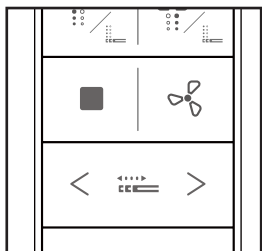

a. When the main unit is powered off, long press the "stop button" of the remote

control until the status light of the remote control flashes, at this time, the remote control enters the code matching state with the main unit.

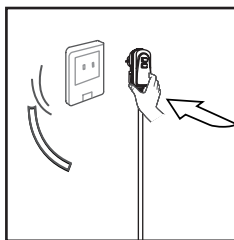

b. Connect the power supply of the host, the leakage protection plug light is on, and after about 15

seconds, the host "beep" sounds halfway, the status light of the remote control is off, that is, the code is successful.

If the code matching is unsuccessful, the indicator will automatically off after 30 seconds. Try again as described above. If it is still unsuccessful, Please consult the after-sale service personnel.

4.Press the switch button

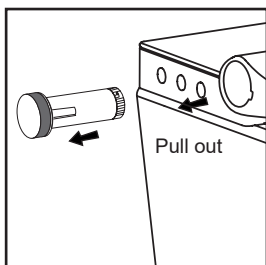

a. Pull the rotate knob remote out horizontally (note that the knob snaps to-

ward the top cover of the toilet) as shown

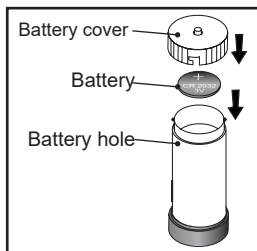

b . Open the battery cover and insert the battery into the battery hole. Note that the bat-

tery is printed with + CR 2032 3V with the positive side of the battery facing up, as shown

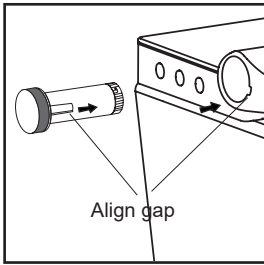

c. Put the rotate knob back into the cover with correct slot position, as shown in

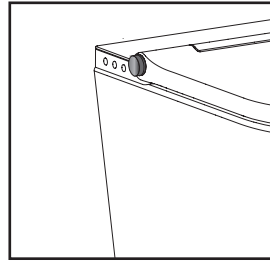

d. Rotate knob remote control is installed

the figure

5. Knob remote re-code matching

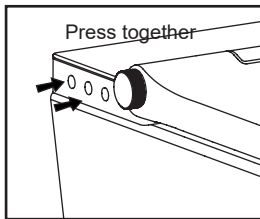

a. Press the "power Wup-ply" and "hip wash button"

of the toilet at the same time. When you release it, you hear a long beep from the host, and the host is in the code state (if there is no beep, it may be due to different pressing, you can try again.

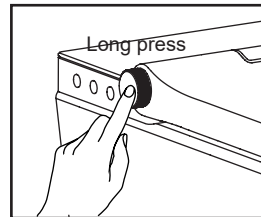

b. Press a n d hold the "knob" until you hear a

long beep from the host, which means that the code is successfully coded; about 10 seconds, the code is successfully coded. If it is unsuccessful, try again according to the above steps; if it is still unsuccessful, please consult the after-sales service.

3.2 Toilet Button Description

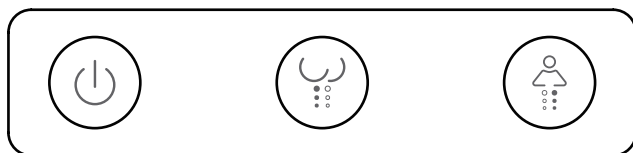

Power Wupply

Rear Wash

Women Wash

Press the power button to turn the toilet ON / OFF.

Press the “Rear wash” button, the Rear wash is activated, the nozzle is extended, gently and safely clean rear position.

Press the “Rear wash” button again or press the stop button on the remote control to end, or it will end automatically after 3 minute.

Press the “Women wash” button, the Women wash is activated, the nozzle is extended, gently and safely clean the women position.

Press the “Women wash” button again or press the stop button on the remote control to end, or it will end automatically after 3 minute.

3.3 Rotate knob operation instructions

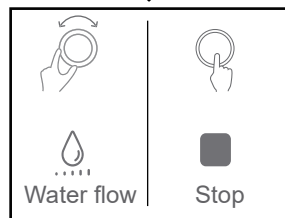
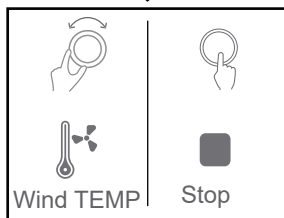
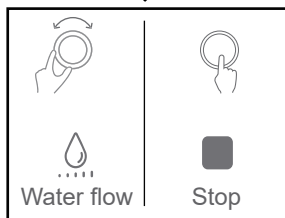
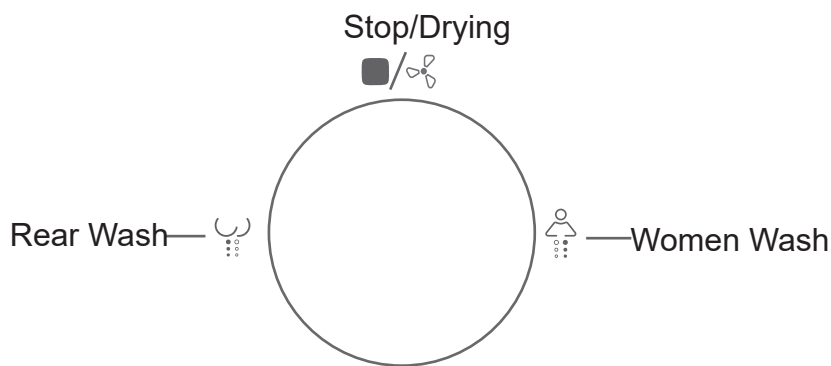

Under the condition of sitting induction, rotate backward to activate rear wash function.

1. Function on short beep, function off short beep; 3 min cycle;

Press the knob to activate the warm air drying function under the condition of sensor and non-flushing.

1. Function on short beep, function off short beep; Long beep at both ends and short beep in the

Under the condition of induction, turn forward to activate the front wash function.

1. Function on short beep, function off short beep; Long beep at both ends and short beep in the middle of gear ad-

2. Under the condition of washing, the forward rotational flow becomes larger, and 5 gears can be adjusted, and 1 gear can be adjusted.

3. Under the condition of washing, the backspin flow becomes smaller and can be adjusted in 5th gear. Adjust the 1st gear with a sound of beep and the minimum duration of beep.

Press the knob buttock to stop Rear Wash.

middle of gear adjustment; 4 min cycle;

2. In the drying state, the front rotation can adjust the wind temperature to increase, and the fifth gear can be adjusted. The first gear can be adjusted.

3. In the drying state, the wind temperature can be reduced by backspin adjustment, with 5 gears adjustable and 1 gear adjusted.

Press the knob to warm the air and stop drying.

justment; 3 min cycle;

2. Under the condition of washing, the forward rotational flow becomes larger, and 5 gears can be adjusted, and 1 gear can be adjusted.

3. Under the condition of washing, the backspin flow becomes smaller and can be adjusted in 5th gear. Adjust the 1st gear with a sound of beep and the minimum duration of beep.

Press the knob to stop front wash.

3.4 Remote button operation instructions

This intelligent toilet is operated by knob and remote control. Knob can control buttock to wash, woman to wash, dry and stop. Other functions are controlled by the remote control, including Settings that are also changed by the remote control. Press the corresponding button on the remote control to activate the corresponding function. The button will briefly light up in the white backlight and disappear after 5 seconds.

In any case, stop the button for the highest priority response;

If the remote control is not available, please check whether the battery is installed or whether the battery is charged.



Rear Wash

Press the “Rear wash”, the status indicator flashes off automatically, and the system buzzer “buzzes” to gently and safely clean the rear position.

Conditions: in the seat induction conditions.

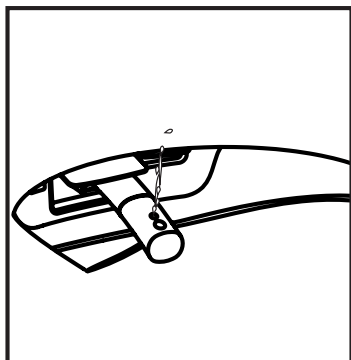

“Rear wash” is activated, and the nozzle slowly sticks out.

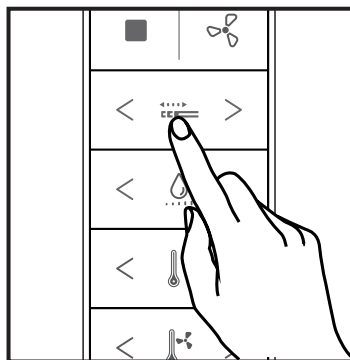

Press “>” in the nozzle position adjustment to move the nozzle forward; Press “<” to move the nozzle backward.

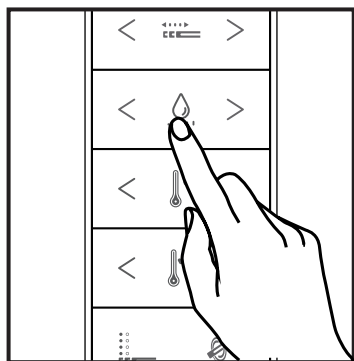

Press “>” in the water flow adjustment to increase the water intensity; press “<” to decrease the water intensity.

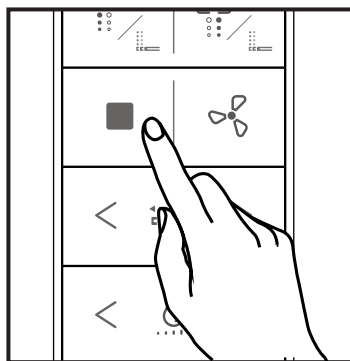

Press the “Stop” button to stop the “Rear wash” or wait for 3 minute to end automatically.



Women Wash

Press the “Women wash”, the status indicator flashes off automatically, and the system buzzer sounds a “beep”, to gently and safely clean the women position.

Conditions: in the seat induction conditions.

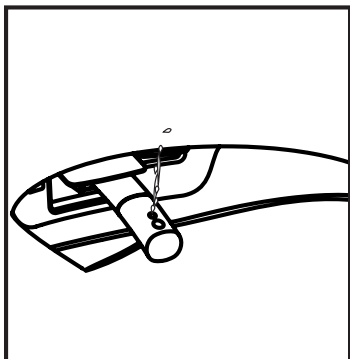

“Rear wash” is activated, and the nozzle slowly sticks out.

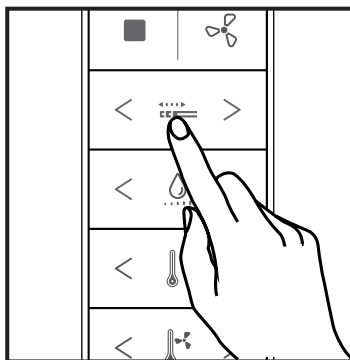

Press “>” in the nozzle position adjustment to move the nozzle forward; Press “<” to move the nozzle backward.

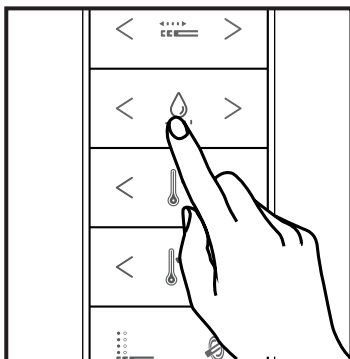

Press “>” in the water flow adjustment to increase the water intensity; press “<” to decrease the water intensity.

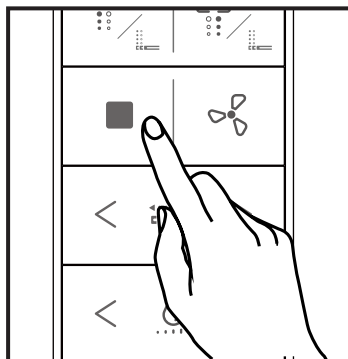

Press the “Stop” button to stop the “Woman wash” or wait for 3 minute to end automatically.



Warm air drying

Press the "Warm Air Drying" button to blow out comfortable warm air.

Conditions: in the seat induction conditions.

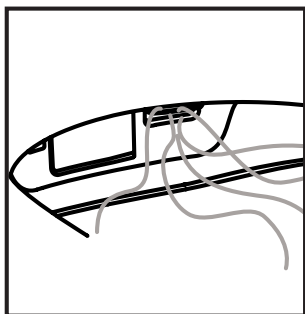

"Warm Air Drying" is activated, the warm air cover is opened, and comfortable warm air is blown out.

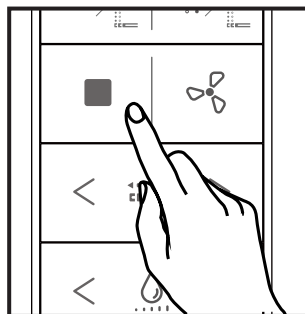

Press the "Stop" button to stop "Warm Air Drying" or wait for 4 minutes to stop automatically.



Mobile massage wash

There are 5 levels for the nozzle position.

Condition: Rear wash or Women wash function have been activated.

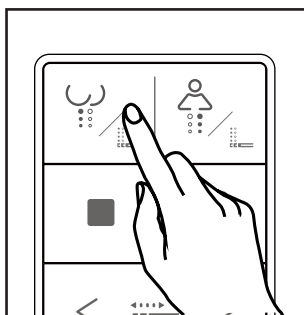

When the Rear wash or Women wash is activated, press the "Rear wash or Women wash" key again to activate the mobile cleaning under this function, and the nozzle will move back and forth.

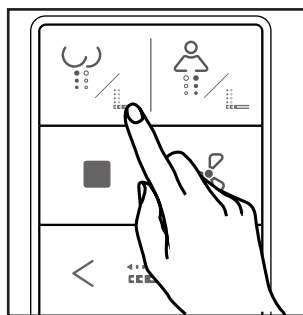

Press "Rear wash or Women wash" again to stop "Mobile Wash" to switch back to Hip Wash / Women's Wash, or wait for 3 minutes and stop automatically.



Water flow adjustment

There are 5 levels of nozzle position adjustment. The default is 3 level .

Condition: Rear wash or Woman wash function has been activate.

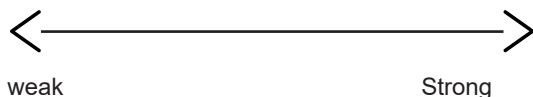

Press the “>” key in the Water flow adjustment to adjust the position of the nozzle position. Each time you press it, it increases by 1 level until it reaches the highest level. Press the “<” key to adjust the nozzle position gear. Each time you press it, it decreases by 1 gear to the lowest gear.



Nozzle position adjustment

There are 5 levels of nozzle position adjustment. The default is 1 level.

Condition: Rear wash or Woman wash function has been activate.

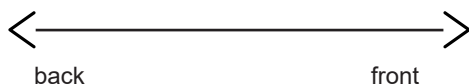

Press the “>” key in the nozzle position adjustment to adjust the position of the nozzle position. Each time you press it, it increases by 1 level until it reaches the highest level. Press the “<” key to adjust the nozzle position gear. Each time you press it, it decreases by 1 gear to the lowest gear.



Water temperature adjustment

There are 5 levels of Water temperature adjustment. The default is 4 level .

Condition: Rear wash or Woman wash function has been activate.

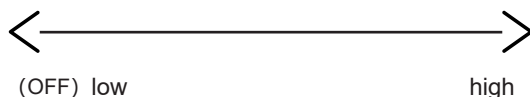

Press the ">" button in the water temperature adjustment to adjust the water spray temperature, each time you press it to increase by 1 gear until the highest level; press the "<" key to adjust the water temperature adjustment gear, every time you press to decrease by 1 gear, until the lowest gear (OFF) .



Warm air temperature adjustment

There are 5 levels of Water temperature adjustment. The default is 3 level .

Condition: in the seat induction conditions.

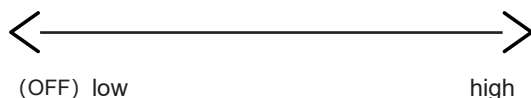

Press the ">" button in the Warm air temperature adjustment to adjust the Warm air temperature, each time you press it to increase by 1 gear until the highest level; press the "<" key to adjust the Warm air temperature adjustment gear, every time you press to decrease by 1 gear, until the lowest gear (OFF) .



Seat temperature adjustment

There are 5 levels of Water temperature adjustment. The default is 4 level .

Condition: Rear wash or Woman wash function has been activate.

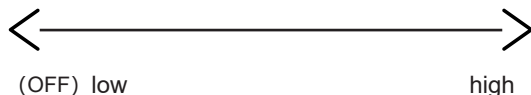

Press the ">" button in the Seat temperature adjustment to adjust the Seat temperature, each time you press it to increase by 1 gear until the highest level; press the "<" key to adjust the Seat temperature adjustment gear, every time you press to decrease by 1 gear, until the lowest gear (OFF) .

Chapter 4 Cleaning and Maintenance.

4.1 Toilet seat body cleaning

Clean the toilet body regularly, or immediately after getting dirty. If cleaning is not performed frequently, the dirt may become noticeable, resulting in stubborn dirt.

Always turn off the power before cleaning the surface of the product

Do not allow water or detergent to enter the product or the power plug, as this may cause short circuit, electric shock, or fire.

Pay attention to discoloration, yellowing or spray peeling due to improper cleaning.

- Do not use abrasive cleaners or cleaners containing chlorine or acids.
- Use only cleaning agents and equipment specific to this application.
- Follow the detergent manufacturer's instructions.
- Never mix detergents.

Wipe with a soft cloth soaked in water and wrung out. A neutral soap solution is the ideal daily cleaner.

4.2 Nozzle and sprayer clean

The retracted nozzle is automatically cleaned by the toilet before and after using the cleaning function.

- Manually cleaning nozzles and sprayer.

Clean the sprayer of the nozzles regularly or as soon as dirt is found.

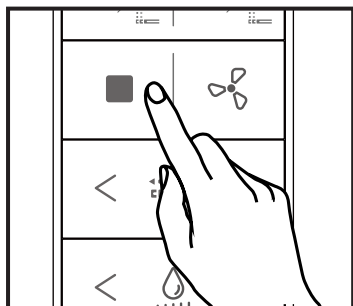

1. Press and hold the stop button to ensure the toilet is in standby

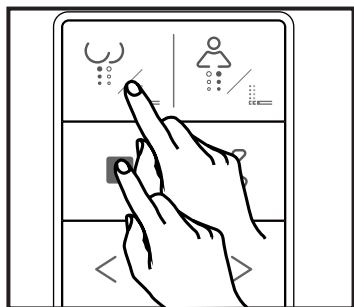

Press the stop button first, and then press the hip washing button. The nozzle extends without water, and the main unit makes a short beep every 3 seconds during the cleaning process.

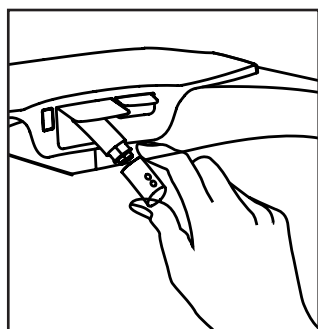

3. Remove the spray head, and clean the spray head with a cloth, sponge or brush and neutral detergent.

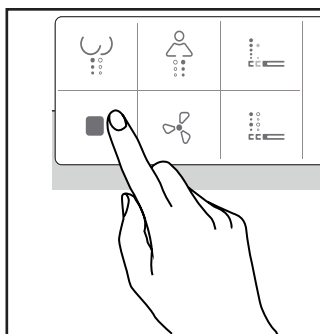

4. Replace the cleaned spray head, click "Stop" on the front of the remote control again to end, and the nozzle will retract.

4.3 Remote control cleaning

Clean the remote control and remote control stand with a soft, damp cloth.

4.4 Deodorizing device cleaning

1. When there is dust on the deodorization box, the amount of inhaled air will decrease. Please use a toothbrush or a small brush to remove the dust. The specific steps are as follows:

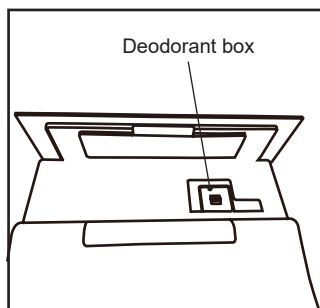

① . Open the glass cover on the rear of the product.

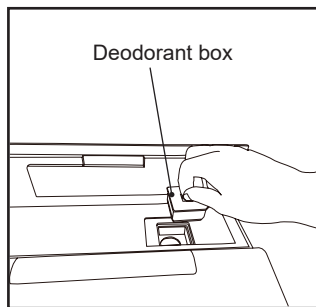

② . Remove the deodorizing box.

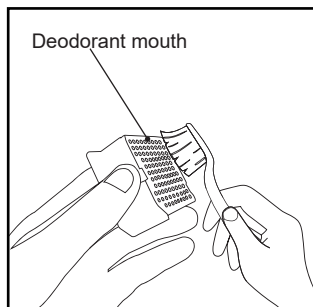

③ . Use a toothbrush or a brush to brush the suction port at the bottom of the deodorization port until there is no dust or paper dust.

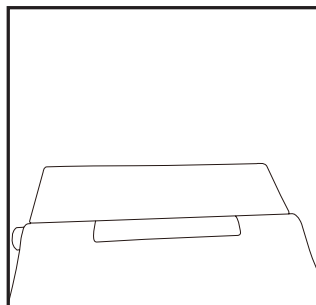

④ . Put the cleaned deodorant box back into the groove on the back of the product, and cover the glass cover again.

Do not wash the deodorizing box with water, otherwise the deodorizing effect will be lost.

Placing the deodorant box in the sun for several hours can extend the life of the deodorant.

2. After cleaning the deodorizing box and the deodorizing suction port, the odor is still generated. Please replace the deodorant.

The specific operations are as follows:

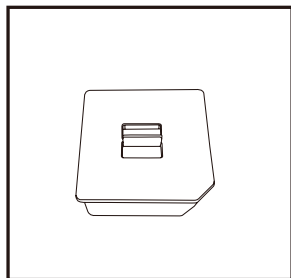

① . Remove the deodorant box from the back of the product.

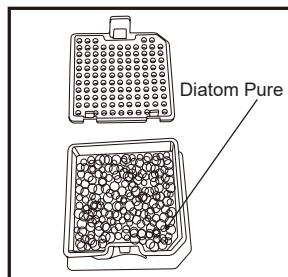

② . Open the deodorant box.

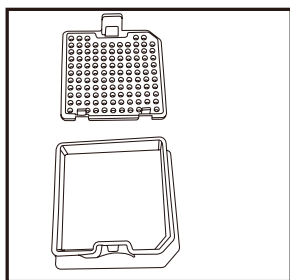

③ . Remove the old diatom pure from the box.

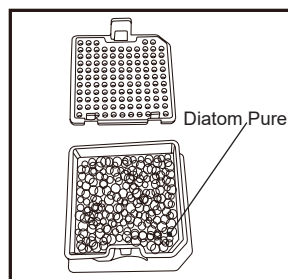

④ . Replace with new diatom pure.

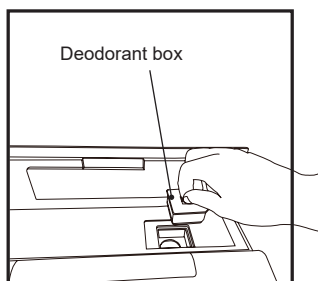

⑤ . Put the new diatom pure box back into the groove of the product box.

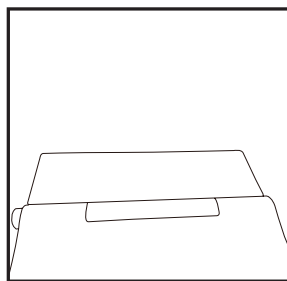

⑥ . Close the glass cover.

4.5 Descaling

Due to the different degrees of softness and hardness of water, scale will form during long-term accumulation, so regular descaling is required. The descaling steps are as follows:

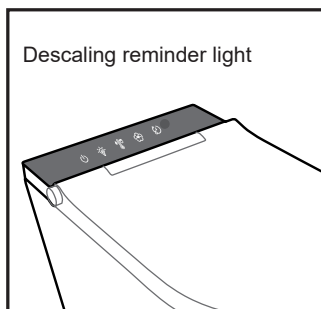

1. Open the rear glass cover.

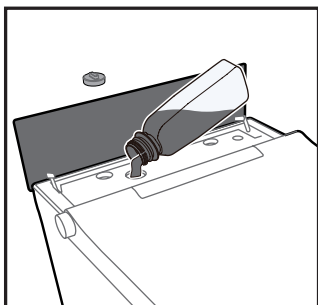

3. After the water tank is drained, the beeping stops; add the descaling solution (recommended coffee machine descaling solution); add the maximum descaling solution capacity: $V_{max} \leq 250\text{ml}$.

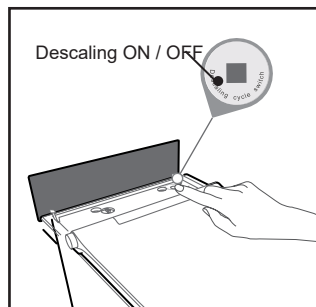

2. Press the descaling key and start the water tank to drain; the nozzle will self-clean the water during the drainage process, accompanied by drops ... beep. If misoperation, the host can be used normally after power off and restart.

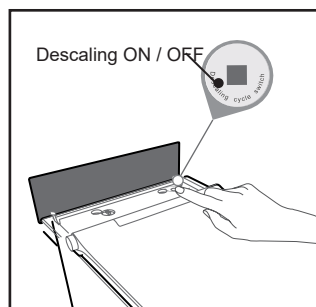

4. Press the descaling key again to start the descaling cycle.

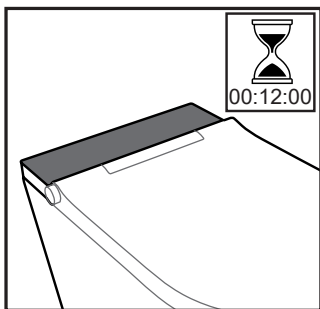

5. During the descaling process, the status lamp flashes. After 12 minutes, the descaling is completed and the status lamp is displayed normally.

Note: The descaling liquid needs to be purchased by the user. It is recommended to purchase a descaling liquid for the coffee machine (it can only be used to clean the limescale, not for other purposes, and not allowed for children to play).

4.6 Waste disposal

Electrical and electronic equipment may contain hazardous or hazardous substances. Do not discard it as unsorted household waste. Please send it to the designated collection point. In this way, you can contribute to resource conservation and environmental protection. Contact your retailer or local authorities for more information.

Used batteries must be disposed of properly. To this end, battery recycling bins with corresponding labels are available in stores and community collection stations where batteries are sold.

To avoid possible suffocation or danger, do not let children play with plastic bags and product packaging. Please keep such packaging materials in a safe place or discard them in an environmentally friendly manner. If possible, keep the packing materials until the end of the warranty period.

4.7 Product maintenance

In the following cases, please close the water inlet valve and remove the hose to drain the water.

- When water may freeze in cold areas.

- When not used for a long time.

It may cause skin infection due to deterioration of residual water.

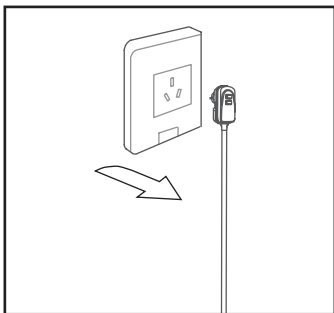

1. Disconnect the power and unplug the power plug.

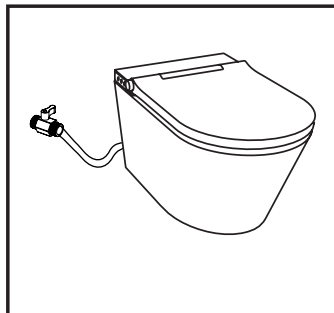

2. Close the valve and stop supplying water to the system.

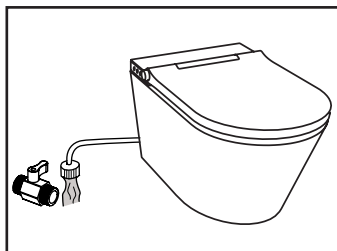

3. Remove the water inlet hose from the water inlet valve and drain the water from the tube.

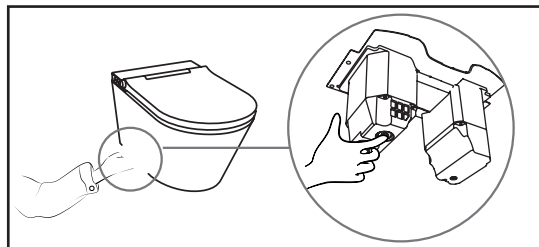

4. Water quality conditions are different in different regions. Please clean the water tank regularly. Blocking the dirt may cause the water flow to become smaller. (Recommended once every 2-6 months). Drain the water in the water tank by pressing the drain button under the water tank. (As shown in FIG).

4.8 Winter Product Maintenance

When freezing may occur in winter, etc., in order to prevent damage to the hose or product due to freezing, please take measures to prevent freezing:

- a. Increase the room temperature;
- b. Close the water inlet angle valve and drain the water from the water inlet hose.

Chapter 5 Fault predication and Troubleshooting

Recommendation: Initial basic operation in case of failure

Turn off the main power of the product, and then turn it on again after at least 3 hours.

If your device still does not work properly after following the instructions described below, please contact your company's customer service center or your dealer.

Condition	possible reason	Solution
Basic function		
Function does not work at all	Power failure	Please wait for power to be restored
	Plug loose or out of touch	Please plug in to ensure the power is restored
	The leakage protection button of the power cord is not on	Please press the leakage switch of the power cord
	In standby mode	Switch to on mode
water leakage	Malfunction	Close the water supply Disconnect the power Call Customer Service Hotline
Remote control		
During operation, the indicator light of remote control keeps flashing	Battery power is low	Replacement battery

Condition	possible reason	Solution
The remote does not work	No battery inserted	Load the battery
	Run out of power	Replacement battery
	Battery is positive and negative	Load the battery correctly
	Defective remote control	Call Customer Service Hotline



Warning

Do not disassemble, repair or modify the product yourself.
It may cause electric shock, fire or malfunction.

Condition	possible reason	Solution
Rear Wash / Women Wash		
It takes slightly long to switch between Rear wash and Woman wash	When switching between Rear wash and Women wash, the spray head needs to be retracted and self-cleaning before extending.	Normal
Cleaning nozzle does not extend	Water inlet hose bend	Exclude water hose bent Call Customer Service Hotline
The cleaning water does not spray out	Water supply was cut off	Please wait for water to be restored
	Inlet angle valve is not open or is blocked by dirt	Open or clean the inlet angle valve
	Water inlet hose bend	Exclude bent water hose Call Customer Service Hotline
	Nozzle blocked	Cleaning nozzle

Condition	possible reason	Solution
Abnormal water spray	Abnormal operation malfunction	Power on again after unplugging for one minute Call Customer Service Hotline
Water spray intensity is too weak	Water spray intensity has been set to "1st"	Adjust the water spray intensity to 2nd, 3rd, 4th or 5th
	Nozzle blocked	Cleaning spout
	Inlet water filter blocked	Cleaning the decompression valve filter
	Deformed of water inlet hose	Call Customer Service Hotline
The water temperature is not high enough	Water temperature has been set to "Off" or "1st gear"	Set the water temperature to 2nd, 3rd, 4th or 5th
Water temperature is too high	Water temperature has been set to "5th gear"	Set the water temperature to 1st, 2nd, 3rd or 4th
Nozzle suddenly stopped spraying water	The function stops automatically after 3 minutes	Normal
Retracted nozzle drips water	The nozzle is automatically cleaned before and after the cleaning function	Normal
Drying		
No reaction	The human body is not within the sensing range	Adjust sitting position, posture, etc.
Warm air temperature is too low	The drying temperature has been set to "1st gear"	Set the drying temperature to 2nd, 3rd, 4th or 5th
Warm air temperature is too high	The drying temperature has been set to "5th gear"	Set the drying temperature to 1st, 2nd, 3rd or 4th

Condition	possible reason	Solution
Deodorizing		
Deodorizing effect is not good	Dust clogging	Cleaning deodorant box
Deodorization produces loud noise	Dust clogging	Clean the deodorizing suction port

In the following cases, be sure to contact the service point.

After reinserting the power plug, the indicator light on the toilet body is still blinking. (Please unplug)

After reinserting the power, the indicator light on the toilet body is still off.

When smoking or abnormal sound occurs. (Please unplug the power plug)

Chapter 6 Technical date

Item		MM-4020-F
Water supply connector		G1/2 to G3/8
Applicable voltage		AC220V~240V, 50/60HZ
Power		1400W
Length of wire		1.8m
Applicable range of water pressure		0.07 ~ 0.75MPa(0.7 ~ 7.5Bar)
Suitable intake temperature		4 ~ 30°C
Applicable ambient temperature		4 ~ 40°C
Waterproof grade		IPX4
Flushing device	Flushing flow rate	540 ~ 770mL/min
	Rinse water temperature	Off, 32 ~ 40°C
	Flushing cycle	3min
	Warm water heating method	Water tank heat storage type
	Maximum heating power	1400W
	Safety device	Temperature fuse, level switch, thermostat
	Backflow preventer	air break
Drying device	Maximum wind speed	5m/S
	Maximum heating power	230W
	Drying cycle	4min
	Warm wind temperature	Off, 40 ~ 60°C
	Safety device	emperature Controller, Temperature Fuse
Seat heating	The surface temperature	Off, 35 ~ 39°C
	Heating power	50W
	Safety device	Thermostat, temperature fuse
Deodorization method		Diatom Pure
Other Safety device		Leakage protection
Net weight		38.5Kg
Size		599*385*400 mm

The final interpretation right of this manual belongs to VIVO Sp. z o. o.
Products are subject to change without notice.

Service card			
Product model			
Serial number		Purchase date	
Dealer		Telephone	
City		Province	
Country		Dealer's stamp	
<p>Maintenance regulations:</p> <ol style="list-style-type: none"> 1. In accordance with the instructions and precautions for use, if a failure occurs after normal use, repair will be performed free of charge during the warranty period. 2. Please contact the company's customer service center or the seller for repairs due to failures during the warranty period, and show the repair service card during repairs. 3. Although it is under warranty, the following conditions will be charged for maintenance. <ul style="list-style-type: none"> -Failures due to carelessness or negligence during use, and failures due to improper repair or modification. -Failure or damage to the mobile installation location. -Faults and damage caused by fire, earthquake, flood, lightning, and other natural disasters, pollution, or abnormal voltage. -Failures and damage caused by the use of unspecified power sources (voltage, frequency). -Used for purposes other than general domestic use, malfunctions or damage. -Cases where this repair card cannot be provided. -When the unit sold, the installation date, the seal of the dealer, etc. are not filled in this repair card or the contents are modified without authorization. 4. This repair card is no longer issued, please keep it properly. 			

About service

Customer rights

Customers have the right to repair free of charge if a failure occurs within Two years from the date of purchase.

However, if the customer's fault or natural disaster occurs, maintenance will be charged even during the warranty period.

First copy: saved by the customer

Crop line 

Service card	
Product number	
Serial number	
Customer name	
Contact number	
Detailed address	
Units Sold	
Contact number	
Purchase date	

Second copy: sent back to company headquarters

Maintenance records			
Maintenance date	Maintanence project	Maintenance unit	Signature of maintenance staff

Thank you for choosing us



VIVO Sp. z o. o.

Add: Bartycka 26/24, 00-716 Warszawa, Polska

Tel. +48 888 593 158

Kom. +48 735 877 668

Email: vivo@majormaker.pl

www.majormaker.pl