

# COMPATIBILITY OF TOILET BOWLS WITH MAJOR&MAKER SMART TOILET SEATS

## GENERAL PRINCIPLES COMMON TO ALL MODELS

- **Bowl shape:** round - oval
- **Top surface of the toilet bowl where it meets the wall:** flat

**An example of an improperly selected bowl**

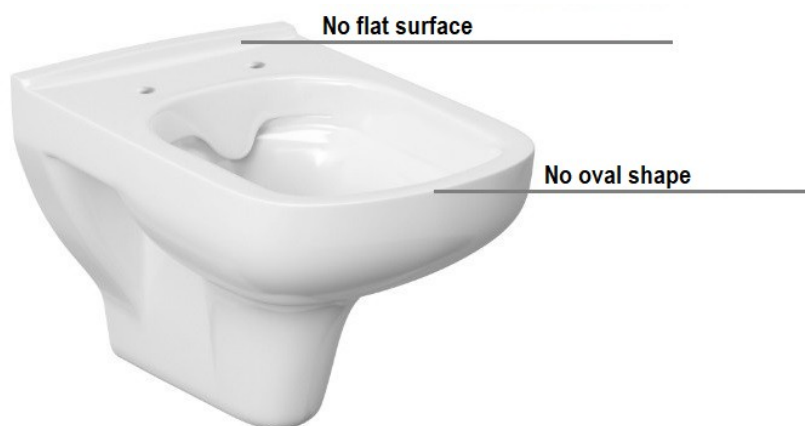

**An example of a correctly selected bowl**

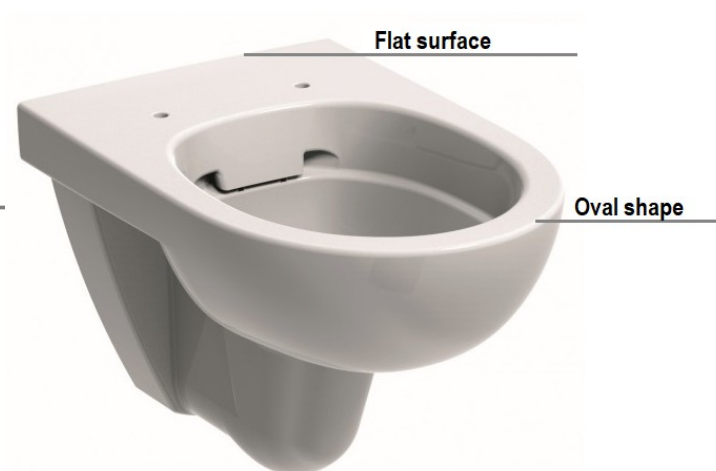
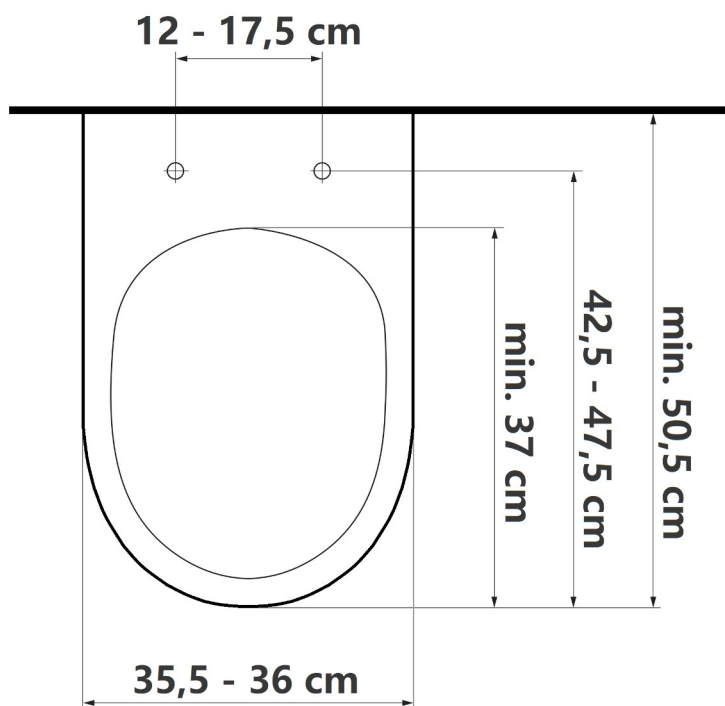

Diagram showing the correct dimensions of the toilet bowl compatible with Major&Maker toilet seat models:  
Crystal, Rubine



Proven models of the best-suited wall-hung bowls for **Major&Maker Rubine (remote control) and Crystal (side panel control)** smart toilet seats:

- Cersanit Larga Oval K120-003
- Roca Meridian A34624L000
- Roca Nexo A34664L000
- Roca Gap Round A34H0N2000
- Geberit Selnova Premium 502.035.00.1
- Rak Ceramics Resort
- Omnires Tampa TAMPAMWBP
- Excellent Stellar CENL.6603.535.WH

Proven models of the best-suited floor standing bowls for **Major&Maker Rubine and Crystal** smart toilet seats:

- Kompakt WC GoodHome Cavally 67,5 cm (available in the Castorama store)
- Kompakt WC Villeroy & Boch Architectura 56861001
- Kompakt WC Villeroy & Boch O.Novo Vita 4620R001
- Kompakt WC Massi Decos MSK-2673ADU

Parameters that a toilet bowl should meet to be compatible with **Major&Maker Rubine and Crystal** smart toilet seats:

- Spacing of holes in the bowl for mounting the toilet seat: 12 - 17.5 cm
- Length from the front edge of the bowl to the end of the bowl hole: minimum 37 cm
- Length from the front edge of the bowl to the mounting holes: 42.5 - 47.5 cm
- Length of the top flat surface of the bowl: minimum 50.5 cm
- Width of the toilet bowl: 35.5 - 36 cm
- Bowl as oval as possible